

> ER SERIES

彈性筒夾

精度5 μ
Integrated
precision
5 μ



高精度5 μ 筒夾表面塗層外觀特點：

- ◎ 防銹蝕
- ◎ 提高表面硬度、耐磨性
- ◎ 清潔度更好，精度穩定
- ◎ 表面更光滑，手感舒適，外觀更漂亮

Advantage:

- ◎ Anti-rust
- ◎ Wear-resisting and Surface hardness improved.
- ◎ Precision stability, good cleaning.
- ◎ Smooth surface, Beautiful appearance.

- ◎ 材質：JIS-SUJ2 ◎ 硬度：46-50HRC 高精度 High Accuracy 高精度 High Accuracy
- ◎ Material: : JIS-SUJ2 ◎ Hardness: 46-50HRC
- ◎ 廣泛應用於鏜、銑、鑽、攻絲、磨、雕刻等加工。
- ◎ Suitable for boring, milling, drilling, tapping, grinding, carving processing.

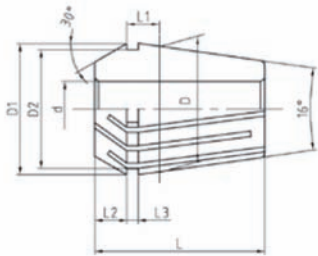

ER11-ER50

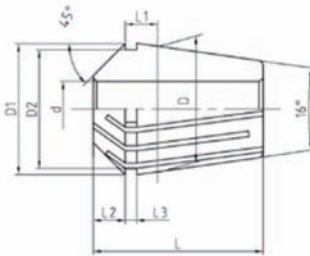

ER8

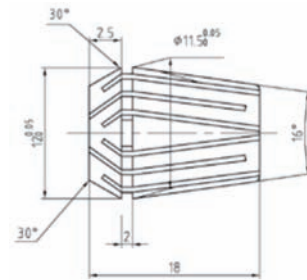

ER12

型號 Model No.	dH7	D	D1	D2	L	L1	L2	L3	彈性收縮量 Collapsible Capacity
ER8	1.0-5.0	8	8.45	6.5	13.5	2.98	1.5	1.2	0.5
ER11	1.0-7.0	11	11.5	9.5	18	3.8	2.5	2	0.5
ER16	1.0-2.5	16	17	13.8	27.5	6.26	4	2.7	0.5
	>2.5-10.0	16	17	13.8	27.5	6.26	4	2.7	1
ER20	1.0-2.5	20	21	17.4	31.5	6.36	4.8	2.8	0.5
	>2.5-13.0	20	21	17.4	31.5	6.36	4.8	2.8	1
ER25	1.0-2.5	25	26	22	34	6.66	5	3.1	0.5
	>2.5-16.0	25	26	22	34	6.66	5	3.1	1
ER32	2.0-2.5	32	33	29.2	40	7.16	5.5	3.6	0.5
	>2.5-20.0	32	33	29.2	40	7.16	5.5	3.6	1
ER40	3.0-26.0	40	41	36.2	46	7.66	7	4.1	1
ER50	6.0-10.0	50	52	46	60	12.6	8.5	5.5	1
	>10.0-34.0	50	52	46	60	12.6	8.5	5.5	2





- 特點:
- ◎ 材質:1 SUJ2
 - ◎ 硬度:HRC 46
 - ◎ 斜度:8
 - ◎ 表面粗度Rz 2.5以內
 - ◎ 同心度按DIN標準全數檢驗.
 - ◎ 挾持範圍ER11=0.5mm
 - ◎ ER16,20,25,32,40=1mm
 - ◎ 內孔經過精密搪磨加工.

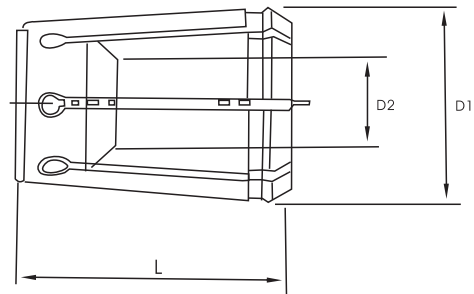

規格 / Specification 單位/UNIT:mm

ER11		ER16		ER20		ER25		ER32		ER40	
SET.	13PCS	SET.	10PCS	SET.	12PCS	SET.	15PCS	SET.	18PCS	SET.	23PCS
NO.	Range mm	NO.	Range mm	NO.	Range mm	NO.	Range mm	NO.	Range mm	NO.	Range mm
ER11-1	1.0-0.5	ER16-1	1.0-0.5	ER20-2	2.0-1.0	ER25-2	2.0-1.0	ER32-3	3.0-2.0	ER40-4	4.0-3.0
ER11-1.5	1.5-1.0	ER16-2	2.0-1.0	ER20-3	3.0-2.0	ER25-3	3.0-2.0	ER32-4	4.0-3.0	ER40-5	5.0-4.0
ER11-2	2.0-1.5	ER16-3	3.0-2.0	ER20-4	4.0-3.0	ER25-4	4.0-3.0	ER32-5	5.0-4.0	ER40-6	6.0-5.0
ER11-2.5	2.5-2.0	ER16-4	4.0-3.0	ER20-5	5.0-4.0	ER25-5	5.0-4.0	ER32-6	6.0-5.0	ER40-7	7.0-6.0
ER11-3	3.0-2.5	ER16-5	5.0-4.0	ER20-6	6.0-5.0	ER25-6	6.0-5.0	ER32-7	7.0-6.0	ER40-8	8.0-7.0
ER11-3.5	3.5-3.0	ER16-6	6.0-5.0	ER20-7	7.0-6.0	ER25-7	7.0-6.0	ER32-8	8.0-7.0	ER40-9	9.0-8.0
ER11-4	4.0-3.5	ER16-7	7.0-6.0	ER20-8	8.0-7.0	ER25-8	8.0-7.0	ER32-9	9.0-8.0	ER40-10	10.0-9.0
ER11-4.5	4.5-4.0	ER16-8	8.0-7.0	ER20-9	9.0-8.0	ER25-9	9.0-8.0	ER32-10	10.0-9.0	ER40-11	11-10
ER11-5	5.0-4.5	ER16-9	9.0-8.0	ER20-10	10.0-9.0	ER25-10	10.0-9.0	ER32-11	11-10	ER40-12	12-11
ER11-5.5	5.5-5.0	ER16-10	10.0-9.0	ER20-11	11-10	ER25-11	11-10	ER32-12	12-11	ER40-13	13-12
ER11-6	6.0-5.5			ER20-12	12-11	ER25-12	12-11	ER32-13	13-12	ER40-14	14-13
ER11-6.5	6.5-6.0			ER20-13	13-12	ER25-13	13-12	ER32-14	14-13	ER40-15	15-14
ER11-7	7.0-6.5					ER25-14	14-13	ER32-15	15-14	ER40-16	16-15
						ER25-15	15-14	ER32-16	16-15	ER40-17	17-16
						ER25-16	16-15	ER32-17	17-16	ER40-18	18-17
								ER32-18	18-17	ER40-19	19-18
								ER32-19	19-18	ER40-20	20-19
								ER32-20	20-19	ER40-21	21-20
										ER40-22	22-21
										ER40-23	23-22
										ER40-24	24-23
										ER40-25	25-24
										ER40-26	26-25

規格 / Specification 單位/UNIT:mm

型號 MODEL	D1	L	PCS/SET	數量/組(規格) D.RANG SIZE	淨重 N.W.(kg)
ER11	11.5	18	13pcs	1,1.5,2,2.5,3,3.5,4,4.5,5,5.5,6,6.5,7	0.3
			7pcs	1,2,3,4,5,6,7	0.2
ER16	17	27	10pcs	1,2,3,4,5,6,7,8,9,10	0.7
			8pcs	3,4,5,6,7,8,9,10	0.6
ER20	21	31	12pcs	2,3,4,5,6,7,8,9,10,11,12,13	0.9
			10pcs	4,5,6,7,8,9,10,11,12,13	0.8
ER25	26	35	15pcs	2,3,4,5,6,7,8,9,10,11,12,13,14,15,16	1.3
			7pcs	4,6,8,10,12,14,16	0.35
ER32	33	40	18pcs	3,4,5,6,7,8,9,10,11,12,13,14,15,16,17,18,19,20	3.3
			11pcs	4,5,6,8,10,12,13,15,16,18,20	2.8
ER40	41	46	6pcs	6,8,10,12,16,20	0.9
			23pcs	4,5,6,7,8,9,10,11,12,13,14,15,16,17,18,19,20,21,22,23,24,25,26	6.5
ER40	41	46	15pcs	4,5,6,8,9,10,12,13,15,16,18,20,21,22,25,26	4.2
			7pcs	6,8,10,12,16,20,25	2