

K51T, K51, K51F 楔式動力卡盤卡爪

WEDGE TYPE POWER CHUCK JAWS

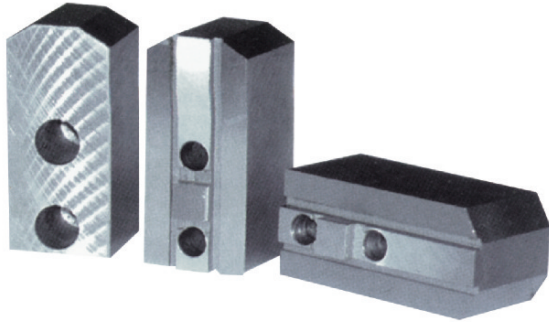

- ◎ 夾持弧面按工件要求可隨機配車或配磨。
- ◎ 連接剛性強，夾持精度高。
- ◎ 夾持直徑的調整主要靠更換卡爪實現，尤其適用於加工大批量零件。

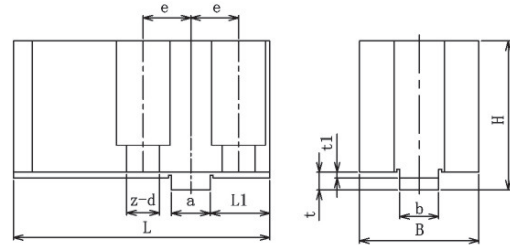

規格 Spec	L	L1	B	H	a	b	e	t	t1	z-d
160	70	18	35	42	11	11	14	5	1.5	2-9
200	86	20	40	50	13	13	16	6	2	2-11
250	105	25	45	58	15	15	20	7	2.5	2-13
320	130	28	50	69	18	18	22.5	8	3	2-15
400	160	40	50	80	20	20	30	9	3.5	2-17
500	190	56	55	85	22	22	39	9	3.5	2-19
630	235	76	60	100	24	24	50	10	4	2-22

日系卡盤軟爪系列1

SOFT JAWS FOR JIS STANDARD

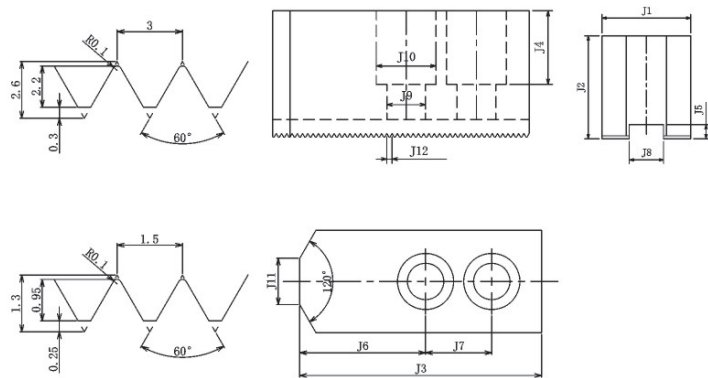
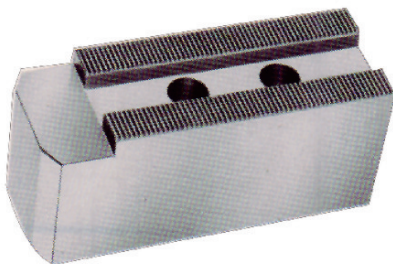

規格 Spec	J1	J2	J3	J4	J5	J6	J7	J8	J9	J10	J11	J12	螺絲 Screw
6	30	34	80	26	3.5	41	25	11	9	14	10	1.5×60°	M8
8	36	40	90	27	3.5	45	25	14	13	17	20	1.5×60°	M12
10	40	40	110	31	6	50	30	16	13	19	25	1.5×60°	M12
12	50	50	130	33	6	60	30	18	15	23	30	1.5×60°	M14
15	62	62	150	43	0.5	55	50	22	22	32	-	3.0×60°	M20
18	62	62	150	43	8.5	55	50	22	22	32	-	3.0×60°	M20

